

310
073

311
073

312
073

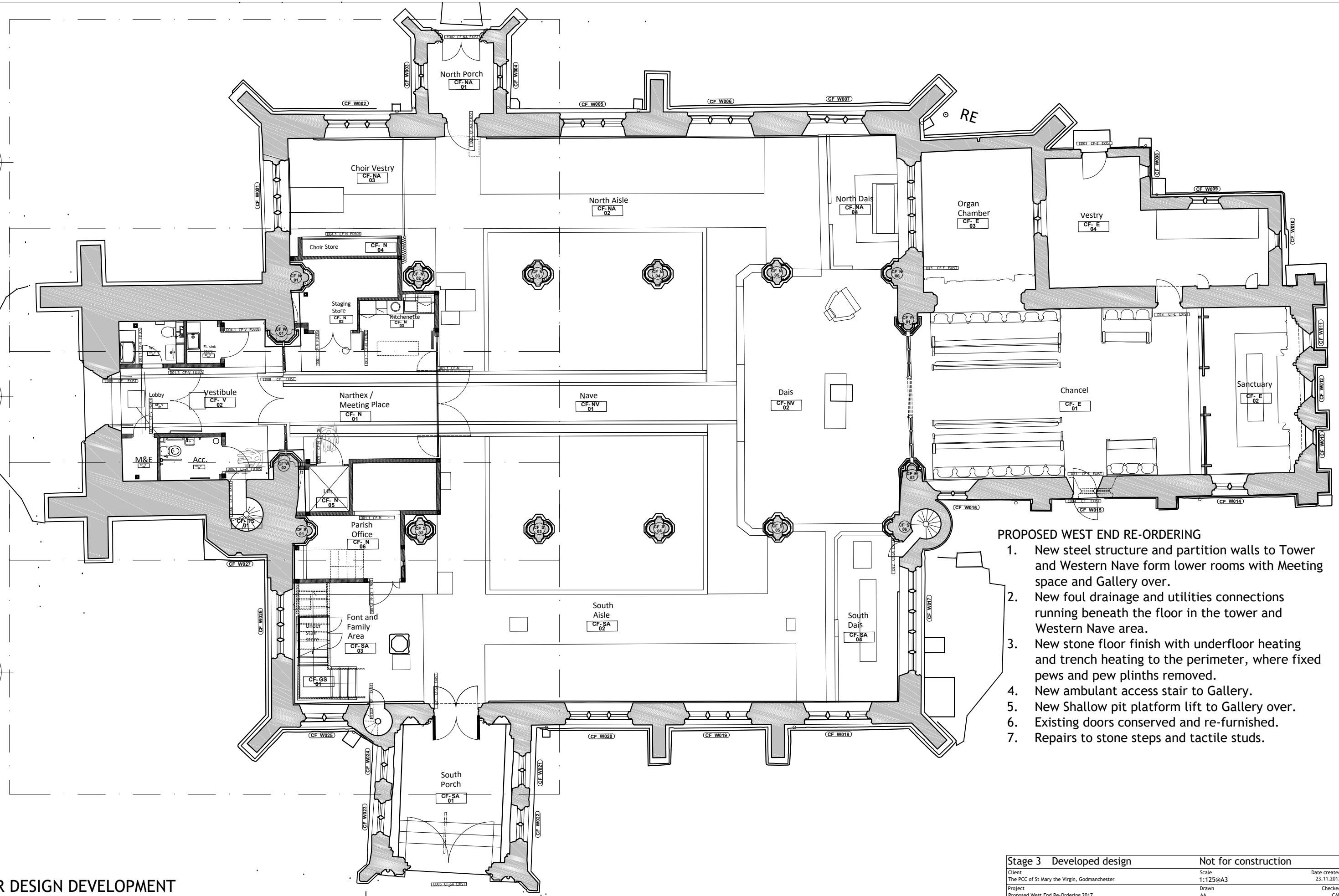

- PROPOSED WEST END RE-ORDERING**
1. New steel structure and partition walls to Tower and Western Nave form lower rooms with Meeting space and Gallery over.
 2. New foul drainage and utilities connections running beneath the floor in the tower and Western Nave area.
 3. New stone floor finish with underfloor heating and trench heating to the perimeter, where fixed pews and pew plinths removed.
 4. New ambulant access stair to Gallery.
 5. New Shallow pit platform lift to Gallery over.
 6. Existing doors conserved and re-furnished.
 7. Repairs to stone steps and tactile studs.

UNDER DESIGN DEVELOPMENT

Rev.	Date	Drn.	Chkd.	Description
3.01	27.11.2017	CAL	CAL	DAC Submission

General notes
 Never scale dimensions from this drawing. Use written dimensions only. Report any discrepancies. Ask if in doubt. Always use latest revision. Note that this drawing is based on a combination of dimensional surveys by others, therefore site verification of dimensional information is particularly important. Read in conjunction with other information from CAL and other consultants. All dimensions are in millimetres unless otherwise stated. CAL accepts no liability for the use of this drawing by parties other than the party for whom it was prepared or for purposes other than those for which it was prepared.

Key plan

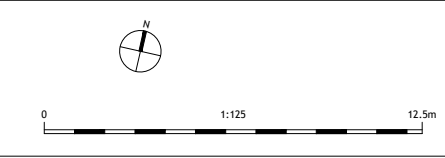

Stage 3 Developed design		Not for construction	
Client	The PCC of St Mary the Virgin, Godmanchester	Scale	1:125@A3
Project	Proposed West End Re-Ordering 2017	Date created	23.11.2017
Drawn	AA	Checked	CAL
Drawing title	Church floor plan Proposed Re-Ordering	Job number	073
		Drawing number	205
		Revision	3.01